

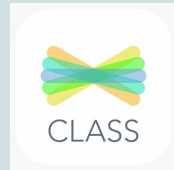

# Parents' Guide to Seesaw



## Logging In - [Tutorial](#)

### Students.

- **Student Portal:** Students can access Seesaw by clicking on the Seesaw Class Icon.
- **Sign in using Google**
  - Enter the students email address and password (@walnutcreeksd.org)
- **Alternatively, use the QR Code/Home Learning Code** - Teachers may email student remote Home Learning Codes to families. Type in the 12 digit code or scan the QR code with your student's device.

Student Sign In

Sign In with Google

Email

Password

[Forgot Password?](#) Student Sign In

### [Remote Learning with Seesaw](#)

### Families



- Teachers will send an invite to all parents to join their classroom as a family member.
- Family members will click on the link to set up their account.
- Family members can use the [Seesaw website](#) or [Seesaw Family App](#) on iOS and Android devices to log in and view their child's journal of work.

# Viewing Work

## Student View

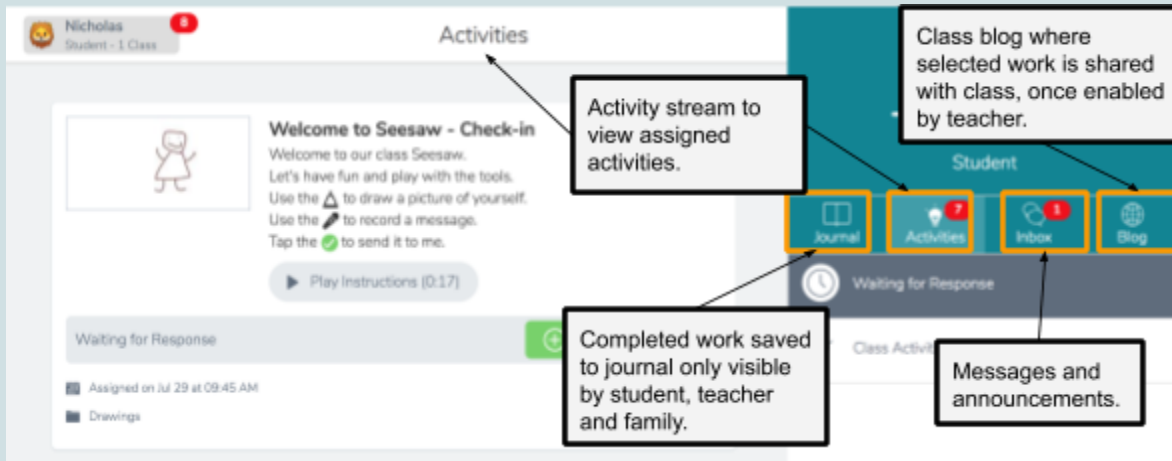

## Family View

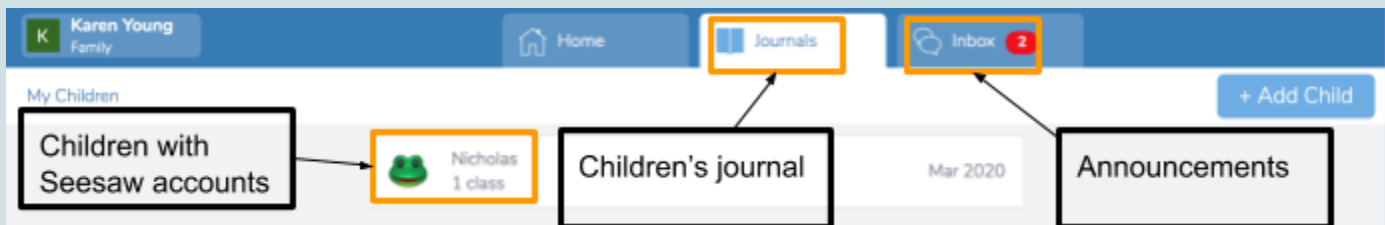

Parents/guardians use the Family App to view their child's work and announcements sent by the teacher. Family accounts cannot respond to assigned activities or post directly to a student journal.

## Submitting Work

- Students click on the +Add Response button to respond to assigned activities.
- Students then complete the activity per teacher directions either on-line or offline.

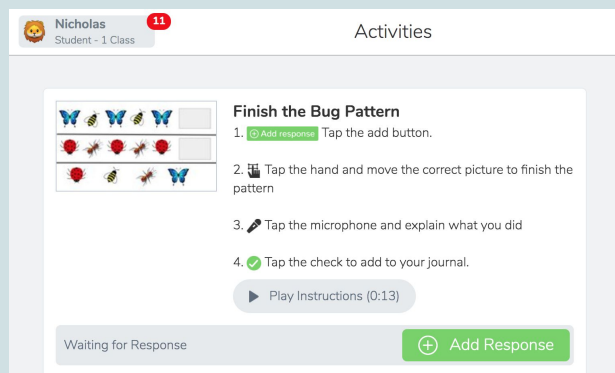

- Once completed, students click the green check mark to submit their work to their teacher.



## Journal

- Seesaw automatically creates and stores all completed work in your student journal.

## Blog

- The Blog feature is used to showcase student work and class projects for classmates and families to see.

## Key Tasks

- [Student - Create a post](#)
- [Student - Responding to Activities](#)
- [Tour of the Seesaw Class App](#)

## More Resources

- [Welcome to Seesaw video for students](#)
- [Seesaw for Parents](#)
- [Frequently Asked Questions](#)- Troubleshooting

If you're needing technical support, contact our WCSD IT team  
by emailing [help@walnutcreeksd.zendesk.com](mailto:help@walnutcreeksd.zendesk.com)